

# ISA - M/Y LIBERTY FOR SALE

<b>BUILDER</b>	ISA
<b>MODEL</b>	50
<b>LENGTH</b>	50 m
<b>BEAM</b>	9 m
<b>DRAFT</b>	2.6 m
<b>BUILT</b>	2011
<b>REFIT</b>	2021
<b>GUESTS</b>	12
<b>CABINS</b>	6
<b>CRUISE SPEED</b>	13 knots

## PRICE

€ 16,500,000



## SPECIFICATION

Builder - Isa

Built - 2011/2021

Length - 49,95 M

Beam - 9,00 M

Draft - 2,55 M

Guests - 12 In 6 Cabins

Cruising Speed - 12 Kn

Hull - Steel/Aluminium

Gross Tonnage - 495

Engines - 2 X Mtu 12V 4000 M71

**ASKING PRICE: € 16,900,000**





**FLACKTON YACHTING**  
Superyacht





 **FLACKTON YACHTING**  
Superyacht solutions

## INTRODUCTION

The 50 meters (164ft) M/Y LIBERTY was delivered by ISA Yachts in 2011 and presents in fantastic condition following her 10-year class survey in Summer 2021.

The yacht's interior has been designed by Rene Van Der Velden and her exterior styling is by Andrea Vallicelli.

Her sleek, dark grey hull and dynamic lines convey a sense of power and speed that turns heads. Fully stabilized and capable of speeds in excess of 15 knots, she is comfortable, fast and remarkably fuel-efficient.

Liberty's interior layout sleeps up to 12 guests in 6 cabins, including a master suite, 1 VIP stateroom, 2 double cabins and 2 twin cabins. She is also capable of carrying up to 11 crew onboard to ensure a relaxed luxury yacht experience.

Timeless styling, beautiful furnishings and sumptuous seating feature throughout to create an elegant and comfortable atmosphere.

LIBERTY is built to comply to MCA and Lloyds Register standards.

With a cruising speed of 12 knots, a maximum speed of 17 knots and a range of 4,400nm from her 69,000 litre fuel tanks, she is the perfect combination of performance and luxury.

---

Unique Interior  
Decor

Zero Speed  
Stabilizers

Swim  
Platform

Water  
Toys

Beach  
Area



I  
N  
T  
E  
R  
I  
O  
R



M/Y LIBERTY  
MAIN SALON







M/Y LIBERTY  
MAIN SALON





M/Y LIBERTY  
MAIN DINING

 **FLACKTON YACHTING**  
yacht solutions



M/Y LIBERTY  
MAIN DINING

 **FLACKTON YACHTING**  
superyacht solutions



M/Y LIBERTY  
UPPER SALON



**FLACKTON YACHTING**  
Superyacht Solutions



M/Y LIBERTY  
UPPER SALON





M/Y LIBERTY  
OWNER SUITE





M/Y LIBERTY  
OWNER SUITE





M/Y LIBERTY  
OWNER SUITE







M/Y LIBERTY  
OWNER SUITE





M/Y LIBERTY  
OWNER SUITE





M/Y LIBERTY  
OWNER SUITE

 **FLACKTON YACHTING**



M/Y LIBERTY  
OWNER SUITE



M/Y LIBERTY  
OWNER BATH





M/Y LIBERTY  
VIP CABIN





M/Y LIBERTY  
VIP BATH

 **FLACKTON YACHTING**



M/Y LIBERTY  
VIP CABIN







M/Y LIBERTY  
VIP BATH





**M/Y LIBERTY  
GUEST CABIN**

 **FLACKTON YACHTING**



M/Y LIBERTY  
GUEST BATH





M/Y LIBERTY  
GUEST CABIN



E  
X  
T  
E  
R  
I  
O  
R



M/Y LIBERTY  
COCKPIT AREA





M/Y LIBERTY  
EXTERNAL DINING

 **FLACKTON**



M/Y LIBERTY  
EXTERNAL DINING





M/Y LIBERTY  
BOW AREA

**FLACKTON YACHTING**  
Superyacht





M/Y LIBERTY  
EXTERNAL LIVING

 **FLACKTON** YACHTING  
SUPPORT



M/Y LIBERTY  
EXTERNAL LIVING





M/Y LIBERTY  
EXTERNAL LIVING



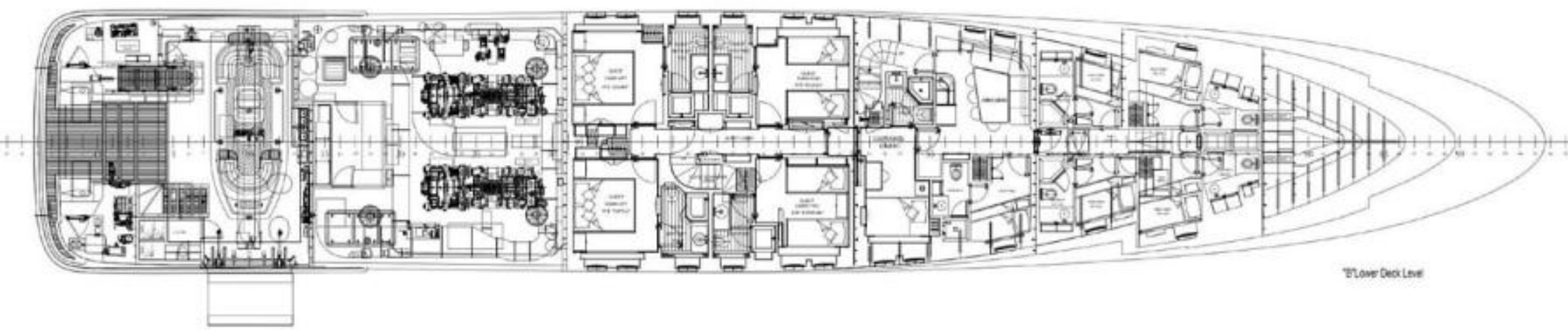
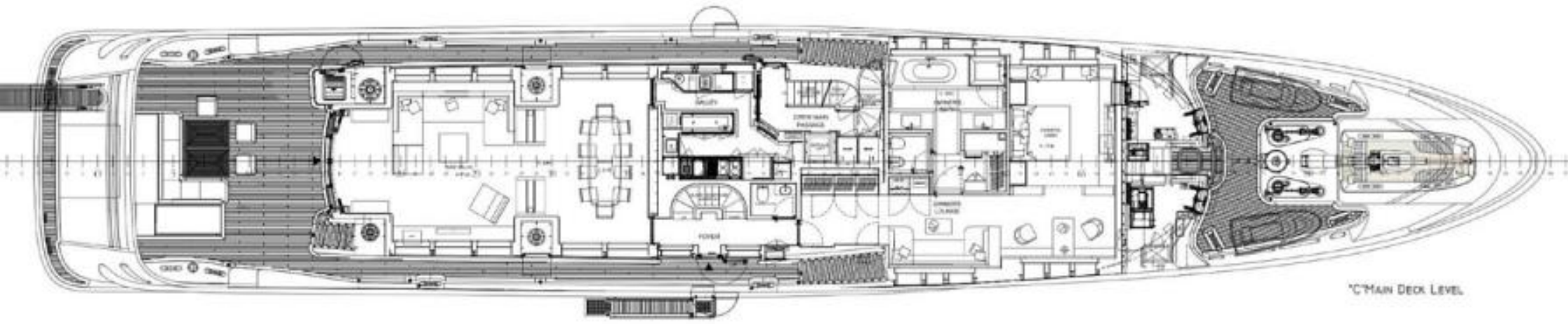

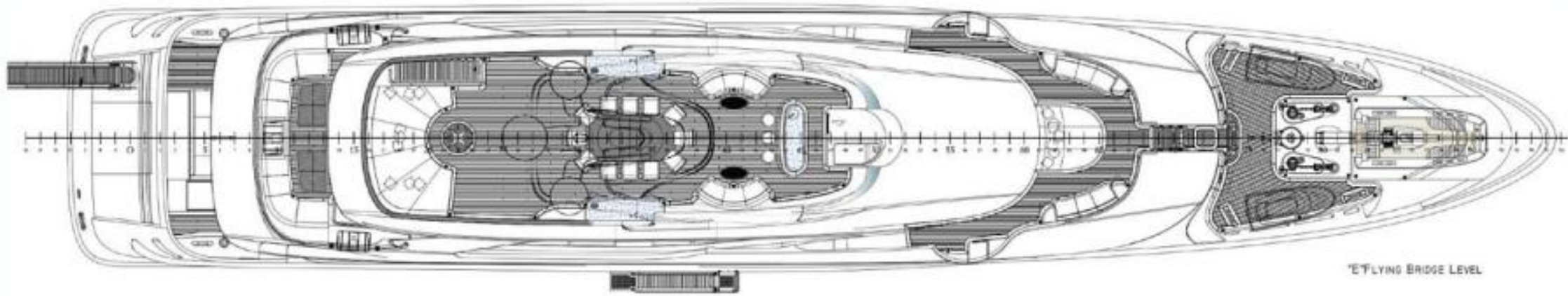

\*FLYING BRIDGE LEVEL

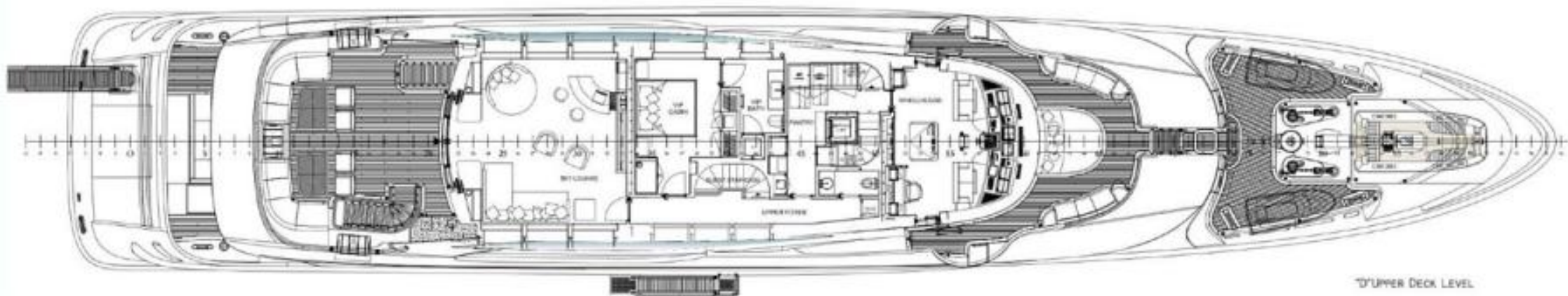

\*UPPER DECK LEVEL



**ELECTRICAL SYSTEM**

- ❖ Electrical Power - 400v AC / 50 Hz 3 Phase
- ❖ Batteries - 34 x 12V
- ❖ Battery Chargers - 12V 35 Amp
- ❖ Shore Power - Output 126 kVA, 200 / 400 VAC – 50 Hz / 2 x 91A
- ❖ Transformers - 2x A/SEA convertors VOLTAGE: 400 V /50HZ

**ENGINE ROOM & MACHINERY**

- ❖ Engines - 2x MTU 12V 4000 M71, 1850 kW (3,700 kW Total) @ 2,000 RPM
- ❖ Engine Hours - Port: 5460; STBD:5387
- ❖ Stabilizers - Quantum Zero Speed
- ❖ Consumption - 220 L/H @ 1270 RPM (12 knots)
- ❖ Range - 4,400 nm @ 11 knots
- ❖ Voltage - 400V, 50 Hz
- ❖ Exhaust mufflers - Aqualift
- ❖ Bow Thruster - 84kW Schottel STT 110
- ❖ Propeller - Five blade Schaffran
- ❖ Gear Box - 2x ZF 76000
- ❖ Steering System - 2x Van der velden hydraulic unit
- ❖ Rudders - 2x Rudders with Duplex Shafts
- ❖ Fuel Capacity - 87,000 L (23,088 US Gal)
- ❖ Water Capacity - 20,000 L (5,283 US Gal)
- ❖ Water Maker - 2x HEM 30 - reverse osmosis systems – 12,000 ltrs/day each
- ❖ Sewage Treatment
- ❖ Plant - Hamman
- ❖ Air Conditioning - Condaria, Fan coil HVAC

**NAVIGATION SYSTEMS**

- ❖ Inmarsat C Satellite Communication - SAILOR TT3606E Inmarsat C GMDSS (C/LRIT and C/ SSAS), Thrane & Thrane

- ❖ Telecom Systems - VOIP lines over VSAT (Milano Teleport) Telephone Exchange and Panasonic Central Unit KXTDA - 30 for 24 stations and 8 outside lines providing internal communication system on board (Panasonic PABX)
- ❖ VHF - 2x Sailor Radio (SAILOR) VHF RT with DSC A Type RT- 6222
- ❖ Intercom Portable VHF - 8x Icom IC-M87 VHF Sets with chargers / Channel 88
- ❖ Portable GMDSS VHF - 2x Saillor SB 3520 with spare batteries
- ❖ EPRIB - SAILOR 4065 GNSS AUTO, beacon unit / 121.5 & 406 MHz,
- ❖ SART - 2x SAILOR SART II
- ❖ Navtex Receiver - Furuno Navtex Receiver NX 700 (display with built in printer)
- ❖ GMDSS Battery Plant - 24V GMDSS Power Supply Unit with monitoring interface into PLC
- ❖ GMDSS Network - 5x GMDSS Network switch
- ❖ Navigation Bridge - Integrated Navigation Bridge with 2 wing stations (PORT & STBD) 2x LED RED Light for night operations on charts and route monitoring.
- ❖ Screens - 5x TFT Hatteland 19 inch screens 16-inch screen for MTU ECU
- ❖ Radar - 2x X-Band Radar / Furuno FAR 2117 Black Box Version / 96NMs Operator panel with tracker ball
- ❖ Gyro interface - for GPS & ECDIS / 6.5Mtr Scanner / ARPA Module
- ❖ ECS - 2x Transas 4000 ECS Units (independent) interfaced with two separate screens in bridge
- ❖ Licensed World Folio UPS - with Radio Holland & updates from Wartsila Inc.
- ❖ UPS - UPS 3000VA (EATON 3150)
- ❖ Magnetic Compass - Spherical Magnetic Compass VENUS, Electronic Magnetic Fluxgate Compass with NMEA0183 interface
- ❖ Gyro Compass - Gyro Compass System NAVIGAT X MK2, Mod Console Repeater Compass 360/10, Sperry Marine Digital Repeater, Sperry Marine
- ❖ Autopilot - Navipilot 4000 Microprocessor controlled digital fully adaptive self-turning heading unit
- ❖ Rudder Angle Indicator System - 4x Rudder Angle Indicators, Sperry Marine
- ❖ Sonar - Forward Looking Sonar FAR500 with control interface on bridge ECS Monitor
- ❖ Echo Sounder - Wheelmark approved dual channel navigation echosounder GDS 102

- ❖ Speed Log - Sperry Naviknot
- ❖ DGPS - SIMRAD MX610
- ❖ AIS - Furuno FA 150 Universale AIS
- ❖ Wind Instruments - B & G H3000
- ❖ Horn - Kahlenberg airhorn Model T1
- ❖ Windscreen Wipers - Marine type Holles 235 KS Wipers / 2 speed 24V DC motors
- ❖ Searchlights - 2x Sanshin 24V DC, ARC/RCL 600 – 24V DC
- ❖ Sextant - Cassens & Plath Sextant Horizon with case
- ❖ Pelorus - Cassens & Plath "SEA" Model Pelorus with case
- ❖ Bridge navigational watch alarm - Watchkeeper PIR module / 24V DC
- ❖ VSAT - Seatel 5004
- ❖ Wifi - 3x Pepawave Shore Wifi & 4G Router

#### AUDIO VISUAL EQUIPMENT AND DECK FACILITIES

- ❖ Zappiti movie server connected to TVs in all cabins
- ❖ Apple TV & Apple airplay throughout the yacht
- ❖ Playstation with virtual reality
- ❖ Sat TV, Sky subscription
- ❖ All systems controlled by i-Pads
- ❖ 100" outdoor movie screen and projector that can be installed on bridge deck aft or sundeck
- ❖ Denon and Marantz amplifiers throughout the guest areas, all Bluetooth connectable
- ❖ B&W speakers throughout. All updated and renewed in 2018

#### GALLEY / LAUNDRY / DOMESTIC

- ❖ 4x Induction cooktop
- ❖ Electrolux Electric Grill and hot plate
- ❖ Oven, Rational Combi master steam oven
- ❖ 2x Electrolux conventional Electric fan ovens

- ❖ Miele M8261-2
- ❖ Deep fryer, Electrolux
- ❖ 600Ltr Freezer / Fridges
- ❖ Dishwasher, Project jet 500+
- ❖ Extraction Hood, SS Custom built
- ❖ 2x Dishwasher, Miele G7856 AE WES
- ❖ 2x Microwave, Miele M8261-2
- ❖ 2x Winecooler, Eurocave Compact 59
- ❖ Coffee Machine, Saeco Exprella
- ❖ 2x 600Ltr Freezer / Fridges, UNIFRIGOR
- ❖ 2x Washers, Miele Professional PW 6065 Plus
- ❖ 2 x Dryers, Miele Professional 1 x GT10 1 x GT08
- ❖ Ironing Machine
- ❖ Customer electric BBQ grill Custom Made (500 x 460)
- ❖ 2x Miele C3 Hoover

#### TENDERS FIRE & SAFETY

- ❖ 21ft (6.4m) Castoldi LC Jet Guest Tender
- ❖ 15ft (4.5m) Zodiac with 40hp outboard
- ❖ Sea-Doo GTX Ltd (2018)
- ❖ Yamaha Cruiser FXHO WaveRunner (2018)

#### DECK EQUIPMENT

- ❖ Anchor Windlass 2x fwd, Muir/ reversing motor
- ❖ Warping Capstans 2x aft, Muir / reversing motor
- ❖ 2x Original Pool High Holding Power Anchors type 'N' fully welded & execution fully balanced, 315 kg each, Finish Galvanised
- ❖ 2x Lengths of 4.5 shackles studlink chain with diameter of 19mm Each total length has two end links, a swivel plate & an anchor D Blot Each anchor has a stainless steel plate welded to the bottom

- ❖ Crane: MOB boat hydraulic crane, SWL 550 kg, Cramm
- ❖ Passerelle / Boarding Ladders: Hydraulic telescopic passerelle, SWL 250 kg, Cramm
- ❖ Hydraulic ladder on starboard, SWL 170 kg, Cramm
- ❖ Manual Marquip ladder for crew on port side and starboard Removable, sockets (Multiplex system) on the stern hatch platform
- ❖ 18 x Underwater lights

## FIRE & SAFETY

- Hi-Fog: Marioff Hi-Fog SPU
- NOVEC 1230 – 51.5 Kg for ER
- Portable FFE spread across the yacht as per LY3 regulations

- ❖ Breathing Apparatus - 2x SCABA sets + 4 Spare Bottles
- ❖ Gas detection - Smoke & Gas detection – Honeywell Sensors
- ❖ Galley - CO2
- ❖ Lifejackets - 4x inflatable & 26 foam
- ❖ Life Rafts - 3 (16 PAX Zodiac Oceangoing A Type)
- ❖ EPIRB - 2
- ❖ Immersion Suits - 26
- ❖ Life Rings - 6

## REFIT WORKS

Shipyard period every winter for regular maintenance and renovation when needed. 10-year survey completed May 2021.

## WORKS COMPLETED OVER WINTER 2020/2021

### INTERIOR

- New carpet fitted throughout the interior
- All new linen
- All new Cashmere blankets

## ENGINEERING

- Completed full 10 years service of main engines
- Full overhaul of generators
- All pumps replaced
- Stabilizers overhauled and updated with latest Quantum parts for quieter performance

## SHIPYARD 2022

### 01. Forward Rescue Tender crane.

Scope of work: Full overhaul and service with replacement of flexible hoses and corroded components.

### 02. Aft Shell Door

Full overhaul and realignment of door, repair of hydraulic leaks and replacement of sleeves to secure dogging and locking mechanism, replacement of flexible.

### 03. Garage Beam crane for guest tender

Full overhaul, crane removed, bushings/bearings replaced, service of winches and replacement of cable.

### 04. Passerelle disembarked, replace hydraulic components.

### 05. Installation of new Atlas Shore power converter

Installation of new shore power converter, link to power management system of yacht.

### 6. Installation of new LOP (Local operating panels) For both Main engines

Installation of new engine control units.

### 07. Installation of new gray and black water pumps

### 08. Air Ducts cleaning

### 09. Diesel generators annual service

### 10. Main engines annual service

### 11. Castoldi tender annual service

### 12. Jet ski's annual service



## Table of Contents

## LIBERTY | ISA | 50

### Disclaimer

Yachts offered are subject to availability. The information provided is believed to be correct but not guaranteed and may not be used for contractual purposes. Specifications provided for information only.